



**U.S. Army Corps  
of Engineers**  
Baltimore District

# Public Notice

**In Reply to Application Number  
CENAB-OPR-M (Bishop, Richard D.)  
2016-62017**

PN 17-30

Comment Period: June 15, 2017 to July 5, 2017

---

**THE PURPOSE OF THIS PUBLIC NOTICE IS TO SOLICIT COMMENTS FROM THE PUBLIC REGARDING THE WORK DESCRIBED BELOW. NO DECISION HAS BEEN MADE AS TO WHETHER OR NOT A PERMIT WILL BE ISSUED AT THIS TIME.**

This District has received an application for a Department of the Army permit pursuant to Section 10 of the Rivers and Harbors Act of 1899 and/or Section 404 of the Clean Water Act (33 U.S.C. 1344) as described below:

APPLICANT: Richard D Bishop (IIEE)  
12530 Knifebox Road  
Greensboro, Maryland 21639

LOCATION: In the Little Choptank River, at North Point Road, Taylors Island, Dorchester County, Maryland.

WORK: To emplace an approximate total of 1,950 linear feet of stone revetment with a 10-foot wide by 10 to 15-foot stone groin to an existing concrete tower base, to extend no more than 10 feet channelward of the approximate mean high water (MHW) shoreline; to construct a 10-foot wide by 15-foot long stone groin at the southwest end of the proposed revetment to extend no more than 15 feet channelward of the approximate MHW shoreline; to construct 5 "T"-shaped 10-foot by 30-foot and 10-foot by 25-foot stone groins along approximately 700 linear feet of shoreline to extend no more than 25 feet channelward of the approximate MHW shoreline; and to construct 65 linear feet of stone revetment/groin system to extend no more than 10 feet channelward of the approximate MHW shoreline. The waterway depths at the project site range from -0.5 to -1.0 feet mean low water. If you have any questions concerning this matter, please contact Mrs. Laura Coleman of this office at (443) 853-2051 or via email at [lamuelle.l.coleman@usace.army.mil](mailto:lamuelle.l.coleman@usace.army.mil).

The purpose of the project is to improve shoreline erosion control.

As part of the planning process for the proposed project, steps were taken to ensure avoidance and minimization of impacts to waters of the United States to the maximum extent practicable.

The Magnuson-Stevens Fishery Conservation and Management Act (MSFCMA), as amended by the Sustainable Fisheries Act of 1996 (Public Law 04-267), requires all Federal agencies to consult with the National Marine Fisheries Service (NMFS) on all actions, or proposed actions, permitted, funded, or undertaken by the agency that may adversely affect Essential Fish Habitat (EFH). The project site lies in or adjacent to EFH as described under Magnuson-Stevens Fishery Conservation and Management Act (MSFCMA) for Juvenile and adult *Scopthalmus aquosus* (windowpane flounder); Juvenile *Pomatomus saltatrix* (bluefish); Juvenile and adult *Paralichthys dentatus* (summer flounder); Egg, larvae, juvenile and adult *Scomberomorus cavalla* (King mackerel), *Scomberomorus maculatus* (Spanish mackerel), *Rachycentron canadum* (Cobia) and *Sciaenops ocellatus* (Red Drum) all managed species under the MSFCMA.

The project has the potential to adversely affect EFH or the species of concern by the alteration of spawning, nursery, forage and/or shelter habitat. The project may have an adverse effect on an approximate total of 2,120 square foot area of EFH as described under the MSFCMA for the species and life stages identified above. This habitat consists of a mostly sand and silt substrate which does not support SAV. The Baltimore District has made a preliminary determination that site-specific impacts would not be substantial. No mitigative measures are recommended at this time to minimize adverse effects on EFH. This preliminary determination may be modified if additional information indicates otherwise and could change the Corps' preliminary determination.

The decision whether to issue a permit will be based on an evaluation of the probable impacts, including cumulative impacts of the proposed activity on the public interest. That decision will reflect the national concern for both protection and utilization of important resources. The benefit, which reasonable may be expected to accrue from the proposal, must be balanced against its reasonably foreseeable detriments. All factors, which may be relevant to the proposal will be considered, including the cumulative effects thereof; among those are conservation, economic, aesthetics, general environmental concerns, wetlands, cultural values, fish and wildlife values, flood hazards, flood plain values, land use, navigation, shoreline erosion and accretion, recreation, water supply and conservation, water quality, energy needs, safety, food and fiber production, mineral needs, and consideration of property ownership and in general, the needs and welfare of the people.

The Corps of Engineers is soliciting comments from the public; Federal, State, and local agencies and officials; Indian Tribes; and other interested parties in order to consider and evaluate the impacts of this proposed activity. Any comments received will be considered by the Corps of Engineers to determine whether to issue, modify, condition or deny a permit for this proposal. To make this decision, comments are used to assess impacts on endangered species, historic properties, water quality, general environmental effects, and the other public interest factors listed above.

Comments are used in the preparation of an Environmental Assessment and/or an Environmental Impact Statement pursuant to the National Environmental Policy Act. Comments provided will become part of the public record for this action. Comments are also used to determine the need for a public hearing and to determine the overall public interest of the proposed activity. Written comments concerning the work described above related to the factors listed above or other pertinent factors must be received by the District Engineer, Department of the Army, Baltimore District Corps of Engineers, Attn: Regulatory Branch, 10 S. Howard Street, Baltimore, Maryland 21201, within the comment period specified above.

Where applicable, the applicant has certified in this application that the proposed activity complies with and will be conducted in a manner consistent with the approved Coastal Zone Management (CZM) Program. By this public notice, we are requesting the State concurrence or objection to the applicant's consistency statement. It should be noted that the CZM Program has a statutory limit of 6 months to make its consistency determination.

The applicant must obtain any State or local government permits which may be required.

A preliminary review of this application indicates that the proposed work would have no effect on Federal listed threatened or endangered species or their critical habitat, pursuant to Section 7 of the Endangered Species Act, as amended. The water depths at the project site are less than -3.0 feet MLW. As the evaluation of this application continues, additional information may become available which could modify this preliminary determination.

Review of the latest published version of the National Register of Historic Places indicates that no registered properties listed as eligible for inclusion, therein, are located at the site of the proposed work. Currently unknown archeological, scientific, prehistoric, or historical data may be lost or destroyed by the work to be accomplished under the request permit.

Any person who has an interest which may be adversely affected by the issuance of this permit may request a public hearing. The request, which must be in writing, must be received by the District Engineer, U.S. Army Corps of Engineers, Baltimore District, 10 S. Howard Street, Baltimore, Maryland 21201, within the comment period as specified above to receive consideration. Also it must clearly set forth the interest which may be adversely affected by this activity and the manner in which the interest may be adversely affected.

It is requested that you communicate this information concerning the proposed work to any persons known by you to be interested and not being known to this office, who did not receive a copy of this notice.

FOR THE DISTRICT ENGINEER:

KATHY B. ANDERSON  
Chief, Maryland Section Southern

# CHOPTANK RIVER

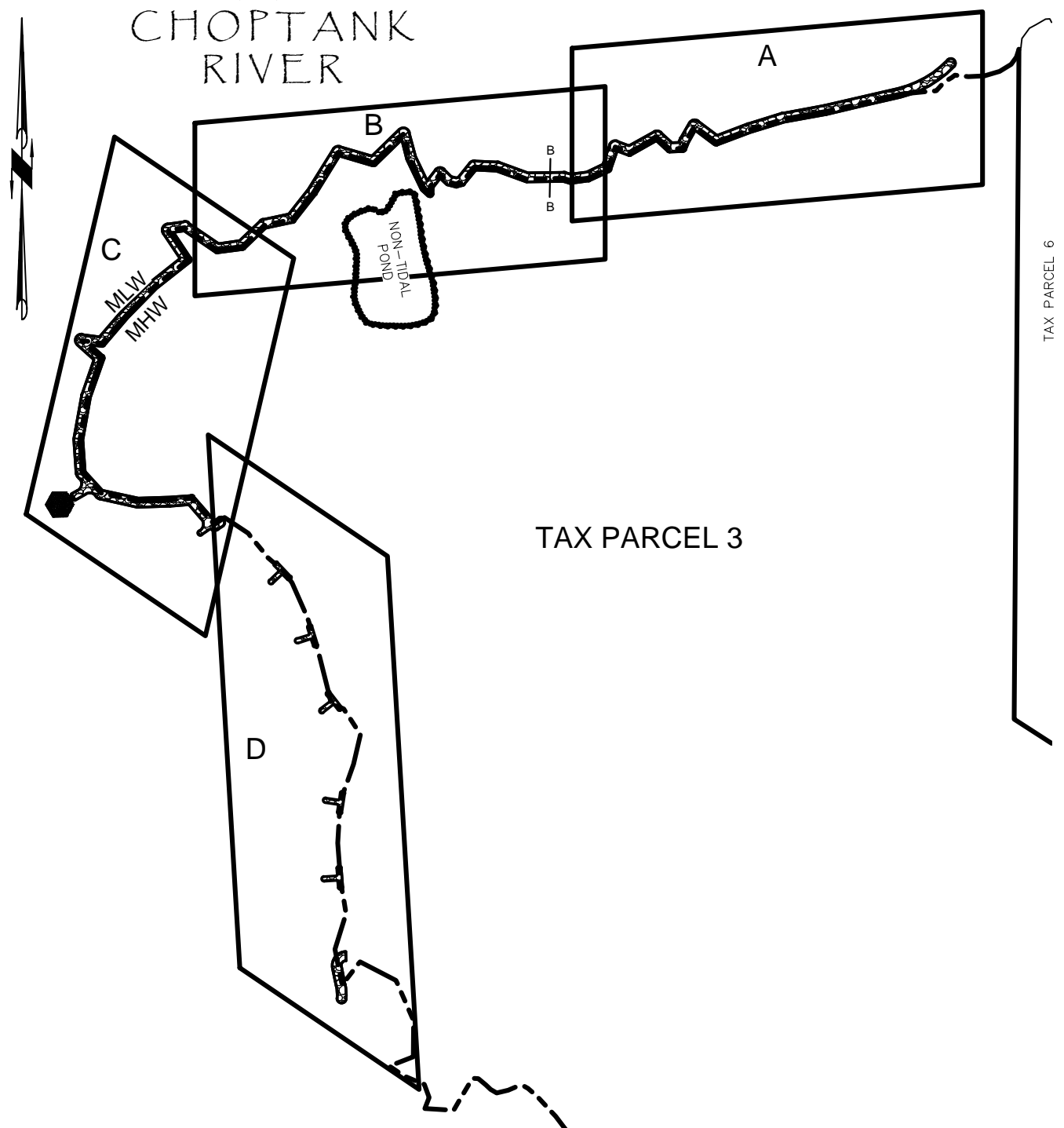

TAX PARCEL 3

TAX PARCEL 6

NOTES: 1) SOUNDINGS ARE IN FEET AND ARE REFERENCED TO MEAN LOW WATER

SHEET 4 OF 10

**OWNER/APPLICANT:**  
 THE RICHARD D. BISHOP Jr., REVOCABLE TRUST  
 C/O RICHARD D. BISHOP, TTEE  
 12530 KNIFE BOX RD  
 GREENSBORO, MD 21639

**PROPOSED CONDITIONS**  
 CONSTRUCT 1,950 LINEAR FEET±  
 STONE REVETMENT  
 6 - 25' STONE GROINS

NORTH POINT RD  
 TAYLORS ISLAND, MD 21669  
 TAX MAP 48, GRID 23, TAX PARCEL 3  
 IN THE FOURTH ELECTION DISTRICT  
 DORCHESTER COUNTY, MARYLAND

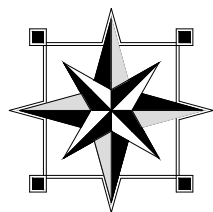

## FINK, WHITTEN & ASSOCIATES, LLC.

LAND SURVEYING      LAND PLANNING  
 CIVIL ENGINEERING      PERMITTING  
 ENVIRONMENTAL CONSULTING

EASTON      CAMBRIDGE  
 410-822-8484      410-228-8885  
 8626 Brooks Drive Unit 103      108 Dorchester Avenue  
 Easton, Maryland 21601      Cambridge, Maryland 21613

[www.FINKWHITTEN.com](http://www.FINKWHITTEN.com)

DATE: 11 / 23 / 2016	SCALE: 1" = 200'
JOB No. D-48-23-3	DRAWN BY: BLW



# LITTLE CHOPTANK RIVER

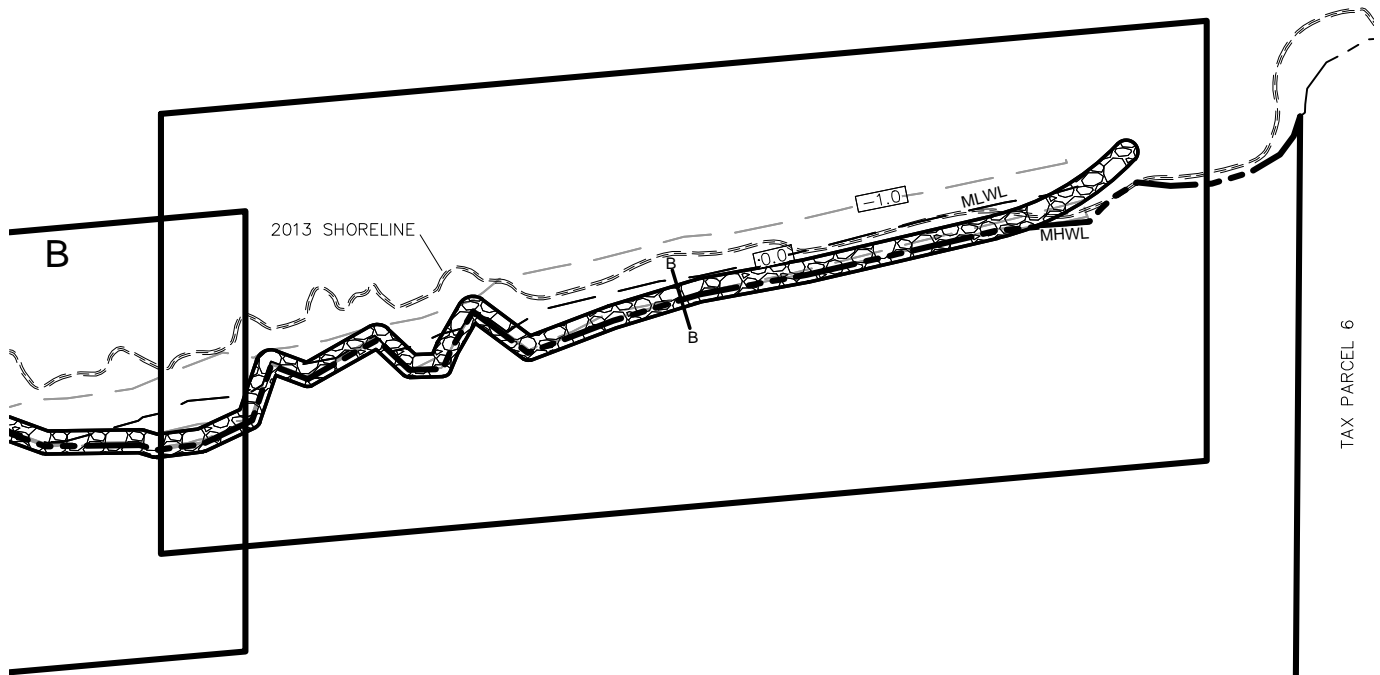

## TAX PARCEL 3

NOTES: 1) SOUNDINGS ARE IN FEET AND ARE REFERENCED TO MEAN LOW WATER

SHEET 5 OF 10

OWNER/APPLICANT:  
 THE RICHARD D. BISHOP Jr., REVOCABLE TRUST  
 C/O RICHARD D. BISHOP, TTEE  
 12530 KNIFE BOX RD  
 GREENSBORO, MD 21639

**DETAIL "A"**  
 CONSTRUCT 1,950 LINEAR FEET±  
 STONE REVETMENT  
 6 - 25' STONE GROINS

NORTH POINT RD  
 TAYLORS ISLAND, MD 21669  
 TAX MAP 48, GRID 23, TAX PARCEL 3  
 IN THE FOURTH ELECTION DISTRICT  
 DORCHSTFR COUNTY. MARYI AND

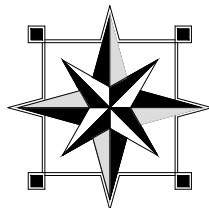

## FINK, WHITTEN & ASSOCIATES, LLC.

LAND SURVEYING      LAND PLANNING  
 CIVIL ENGINEERING      PERMITTING  
 ENVIRONMENTAL      CONSULTING

EASTON      CAMBRIDGE  
 410-822-8484      410-228-8885  
 8626 Brooks Drive Unit 103      108 Dorchester Avenue  
 Easton, Maryland 21601      Cambridge, Maryland 21613

www.FINKWHITTEN.com

DATE: 11 / 23 / 2016

SCALE: 1" = 100'

JOB No. D-48-23-3

DRAWN BY: BLW

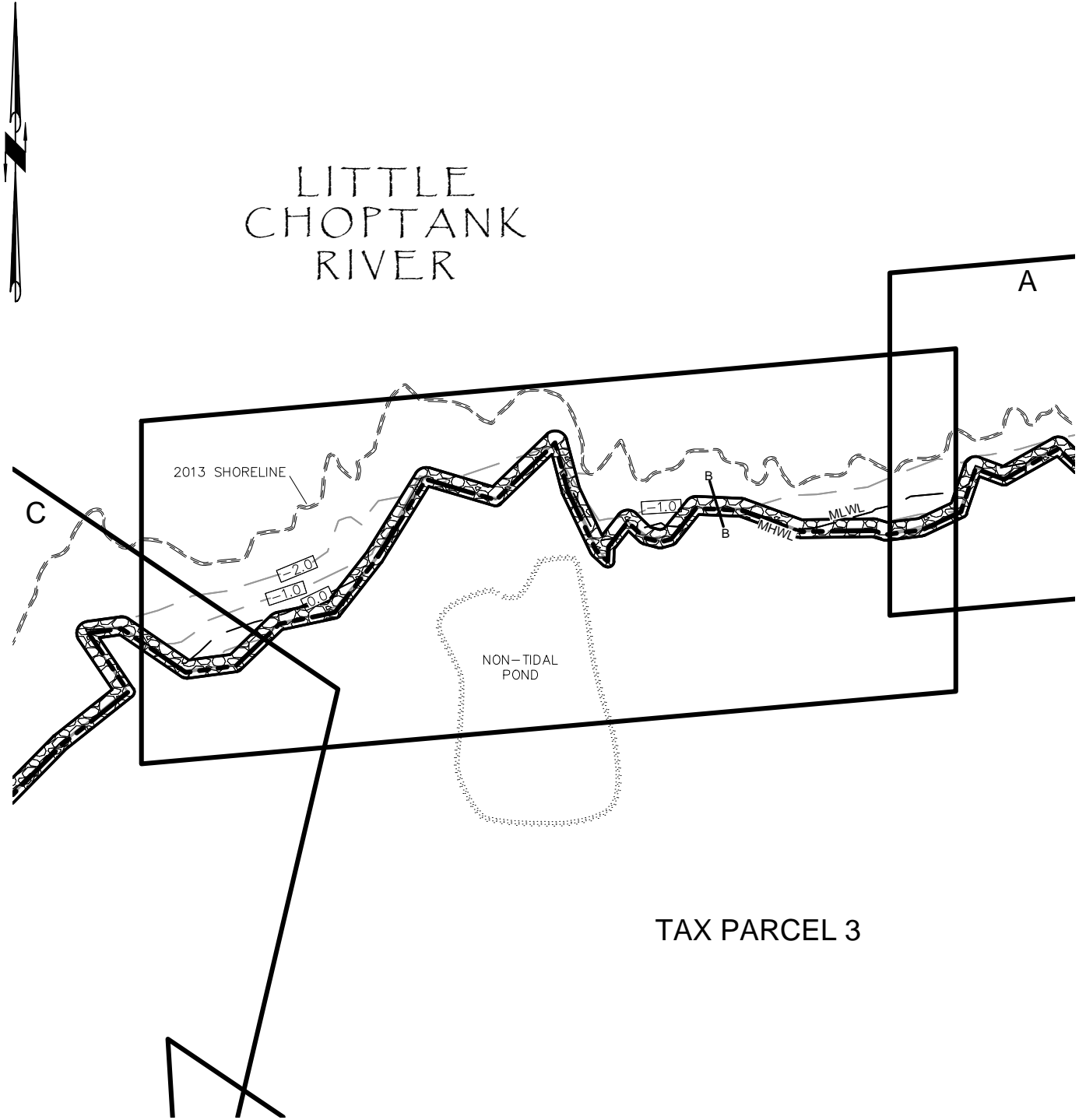

NOTES: 1) SOUNDINGS ARE IN FEET AND ARE REFERENCED TO MEAN LOW WATER

SHEET 6 OF 10

**OWNER/APPLICANT:**  
 THE RICHARD D. BISHOP Jr., REVOCABLE TRUST  
 C/O RICHARD D. BISHOP, TTEE  
 12530 KNIFE BOX RD  
 GREENSBORO, MD 21639

**DETAIL "B"**  
 CONSTRUCT 1,950 LINEAR FEET±  
 STONE REVETMENT  
 6 - 25' STONE GROINS

NORTH POINT RD  
 TAYLORS ISLAND, MD 21669  
 TAX MAP 48, GRID 23, TAX PARCEL 3  
 IN THE FOURTH ELECTION DISTRICT  
 DORCHFSTFR COUNTY. MARYI AND

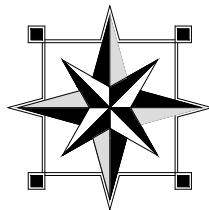

**FINK, WHITTEN & ASSOCIATES, LLC.**

LAND SURVEYING      LAND PLANNING  
 CIVIL ENGINEERING      PERMITTING  
 ENVIRONMENTAL      CONSULTING

EASTON      CAMBRIDGE  
 410-822-8484      410-228-8885  
 8626 Brooks Drive Unit 103      108 Dorchester Avenue  
 Easton, Maryland 21601      Cambridge, Maryland 21613

www.FINKWHITTEN.com

DATE: 11 / 23 / 2016	SCALE: 1" = 100'
JOB No. D-48-23-3	DRAWN BY: BLW



# LITTLE CHOPTANK RIVER

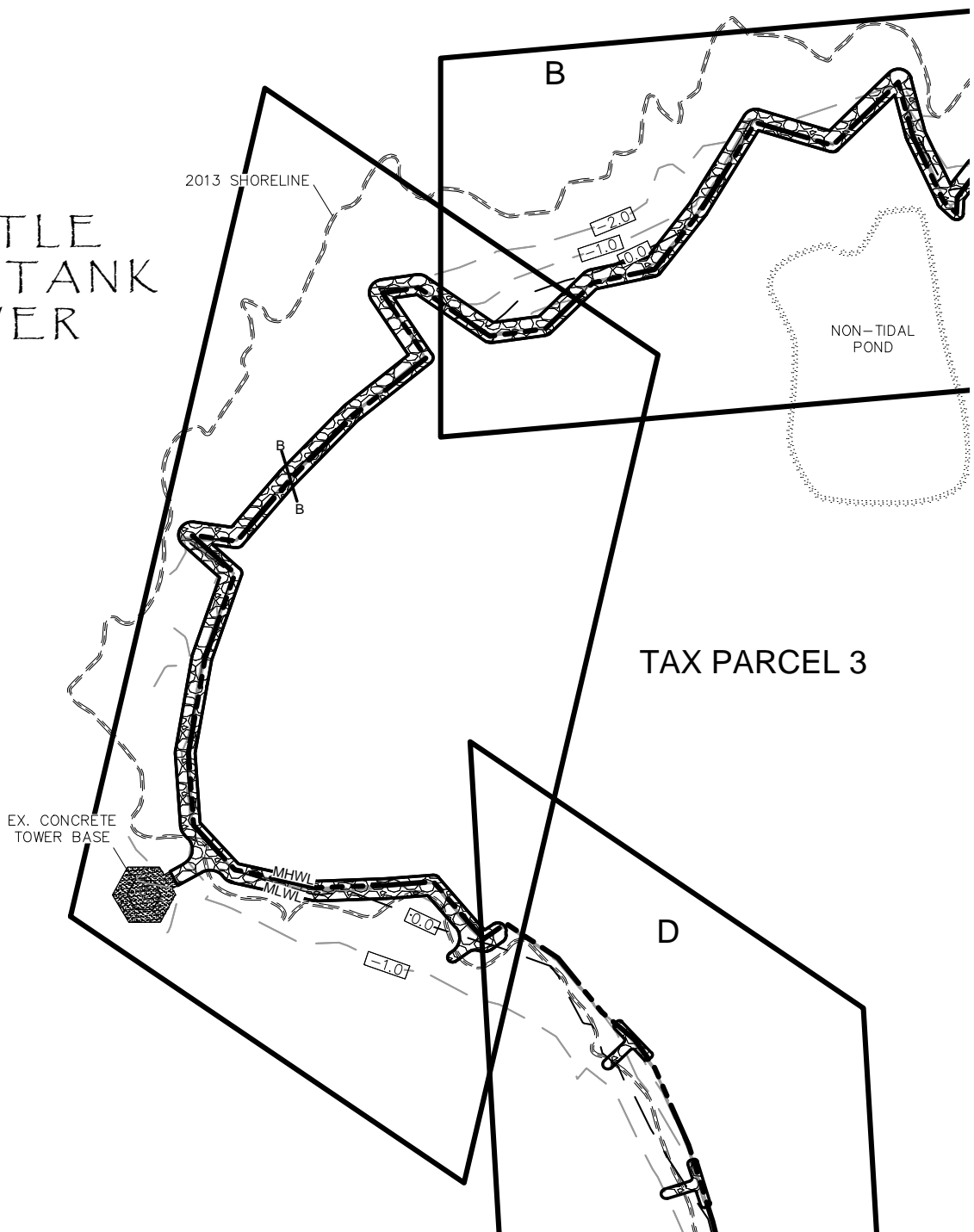

NOTES: 1) SOUNDINGS ARE IN FEET AND ARE REFERENCED TO MEAN LOW WATER

SHEET 7 OF 10

OWNER/APPLICANT:  
 THE RICHARD D. BISHOP Jr., REVOCABLE TRUST  
 C/O RICHARD D. BISHOP, TTEE  
 12530 KNIFE BOX RD  
 GREENSBORO, MD 21639

**DETAIL "C"**  
 CONSTRUCT 1,950 LINEAR FEET±  
 STONE REVETMENT  
 6 - 25' STONE GROINS

NORTH POINT RD  
 TAYLORS ISLAND, MD 21669  
 TAX MAP 48, GRID 23, TAX PARCEL 3  
 IN THE FOURTH ELECTION DISTRICT  
 DORCHFSTFR COUNTY. MARYLAND

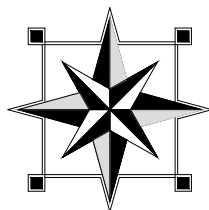

## FINK, WHITTEN & ASSOCIATES, LLC.

LAND SURVEYING      LAND PLANNING  
 CIVIL ENGINEERING      PERMITTING  
 ENVIRONMENTAL CONSULTING

EASTON      CAMBRIDGE  
 410-822-8484      410-228-8885  
 8626 Brooks Drive Unit 103      108 Dorchester Avenue  
 Easton, Maryland 21601      Cambridge, Maryland 21613

www.FINKWHITTEN.com

DATE: 11 / 23 / 2016

SCALE: 1" = 100'

JOB No. D-48-23-3

DRAWN BY: BLW

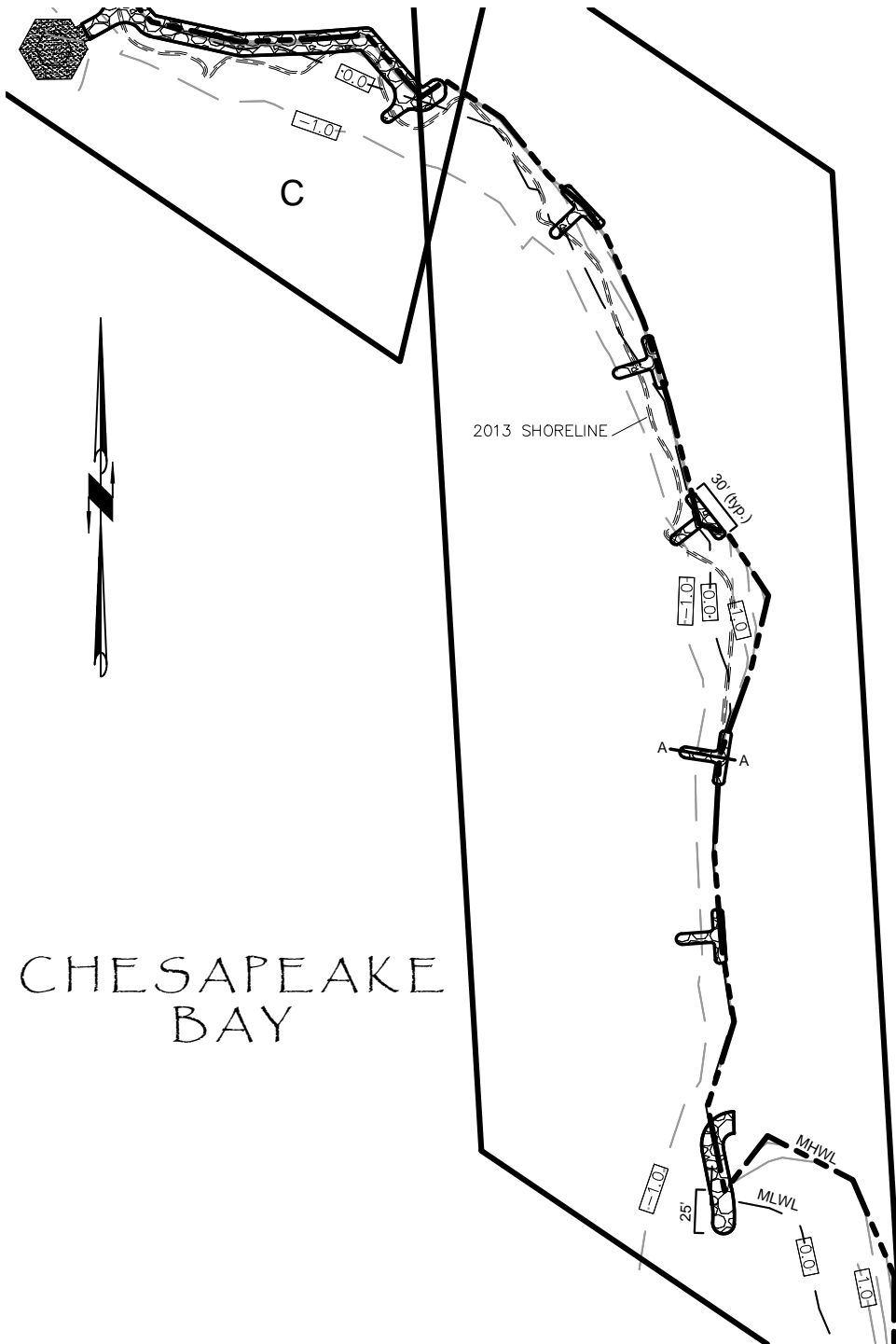

TAX PARCEL 3

CHESAPEAKE  
BAY

NOTES: 1) SOUNDINGS ARE IN FEET AND ARE REFERENCED TO MEAN LOW WATER

SHEET 8 OF 10

**OWNER/APPLICANT:**  
 THE RICHARD D. BISHOP Jr., REVOCABLE TRUST  
 C/O RICHARD D. BISHOP, TTEE  
 12530 KNIFE BOX RD  
 GREENSBORO, MD 21639

**PROPOSED CONDITIONS**  
 CONSTRUCT 1,950 LINEAR FEET±  
 STONE REVETMENT  
 6 - 25' STONE GROINS

NORTH POINT RD  
 TAYLORS ISLAND, MD 21669  
 TAX MAP 48, GRID 23, TAX PARCEL 3  
 IN THE FOURTH ELECTION DISTRICT  
 DORCHFSTFR COUNTY. MARYLAND

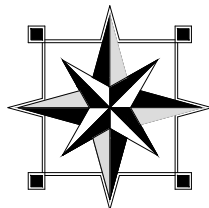

**FINK, WHITTEN & ASSOCIATES, LLC.**

LAND SURVEYING      LAND PLANNING  
 CIVIL ENGINEERING      PERMITTING  
 ENVIRONMENTAL CONSULTING

EASTON      CAMBRIDGE  
 410-822-8484      410-228-8885  
 8626 Brooks Drive Unit 103      108 Dorchester Avenue  
 Easton, Maryland 21601      Cambridge, Maryland 21613

www.FINKWHITTEN.com

DATE: 11 / 23 / 2016

SCALE: 1" = 100'

JOB No. D-48-23-3

DRAWN BY: BLW



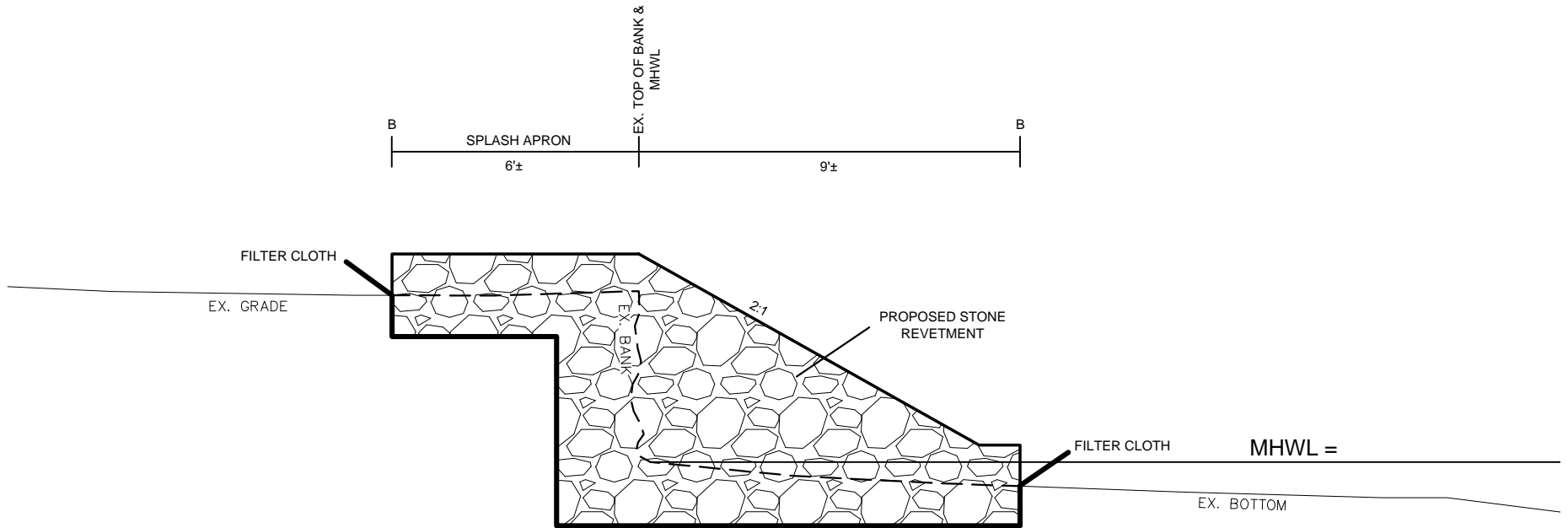

OWNER/APPLICANT:  
 THE RICHARD D. BISHOP Jr., REVOCABLE TRUST  
 C/O RICHARD D. BISHOP, TTEE  
 12530 KNIFE BOX RD  
 GREENSBORO, MD 21639

**STONE REVETMENT CROSS-SECTION B-B**

CONSTRUCT 1,950 LINEAR FEET±  
 STONE REVETMENT  
 6 - 25' STONE GROINS

NORTH POINT RD  
 TAYLORS ISLAND, MD 21669  
 TAX MAP 48, GRID 23, TAX PARCEL 3  
 IN THE FOURTH ELECTION DISTRICT  
 DORCHESTER COUNTY, MARYLAND

SHEET 9 OF 10

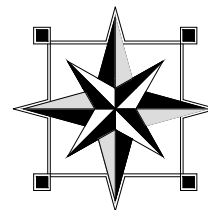

**FINK, WHITTEN & ASSOCIATES, LLC.**

LAND SURVEYING      LAND PLANNING  
 CIVIL ENGINEERING      PERMITTING  
 ENVIRONMENTAL CONSULTING

EASTON      CAMBRIDGE  
 410-822-8484      410-228-8885  
 8626 Brooks Drive Unit 103      108 Dorchester Avenue  
 Easton, Maryland 21601      Cambridge, Maryland 21613

www.FINKWHITTEN.com

DATE: 11 / 23 / 2016

NOT TO SCALE

JOB No. D-48-23-3

DRAWN BY: BLW

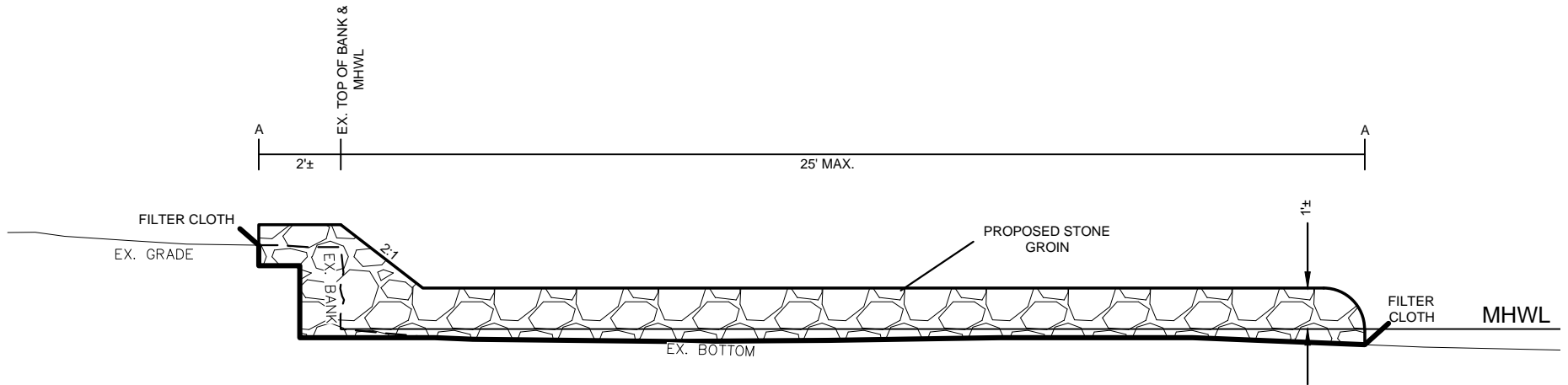

CROSS-SECTION A-A - NOT TO SCALE

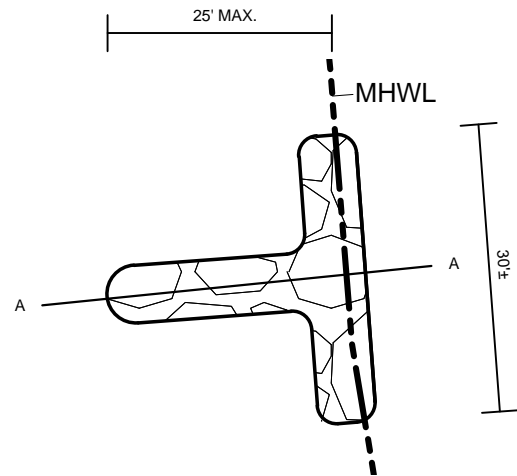

GROIN DETAIL - SCALE 1" = 20'

OWNER/APPLICANT:  
 THE RICHARD D. BISHOP Jr., REVOCABLE TRUST  
 C/O RICHARD D. BISHOP, TTEE  
 12530 KNIFE BOX RD  
 GREENSBORO, MD 21639

**STGONE GROIN DETAIL**

CONSTRUCT 1,950 LINEAR FEET±  
 STONE REVETMENT  
 6 - 25' STONE GROINS

NORTH POINT RD  
 TAYLORS ISLAND, MD 21669  
 TAX MAP 48, GRID 23, TAX PARCEL 3  
 IN THE FOURTH ELECTION DISTRICT  
 DORCHESTER COUNTY, MARYLAND

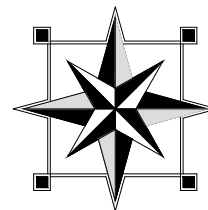

**FINK, WHITTEN & ASSOCIATES, LLC.**

LAND SURVEYING      LAND PLANNING  
 CIVIL ENGINEERING      PERMITTING  
 ENVIRONMENTAL CONSULTING

EASTON      CAMBRIDGE  
 410-822-8484      410-228-8885  
 8626 Brooks Drive Unit 103      108 Dorchester Avenue  
 Easton, Maryland 21601      Cambridge, Maryland 21613

www.FINKWHITTEN.com

DATE: 11 / 23 / 2016

AS SHOWN

JOB No. D-48-23-3

DRAWN BY: BLW